

# How to Apply Cut Vinyl

1.



Best application done in warmer weather above 10 ° C

Clean window / surface with sunlight dish detergent to remove any residue. For larger area put a couple drops of sunlight dish soap in a litre size spray bottle and mist window.

Leave surface wet, this will help with adjusting alignment and bubble removal once vinyl is taped in place.

2.



For larger vinyl it may be easier to cut into separate/smaller *pieces once the vinyl is taped in place.*

*(ie. Logo separate from phone number)*

Align vinyl to area you wish to cover.

Place a piece of masking tape along the top edge of the vinyl to help keep in place, creating a hinge.

3.

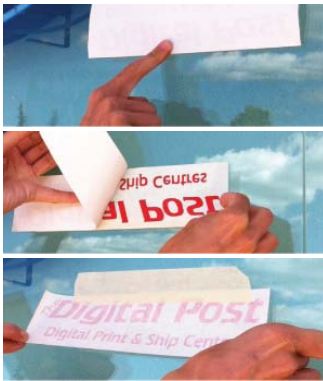

Flip vinyl upward using masking tape hinge & remove backing.

Slowly bring vinyl back down to its original position with adhesive side on window or surface.

If necessary shift or wiggle to adjust/straighten vinyl.

This is where the wet soapy surface from step 1 helps.

4.



Firmly push/squeegee remaining surface water out to the edges using a straight, stiff, plastic edge object *(ie. credit card)*.

Once all water is removed leave to dry in sunlight, this will allow air bubbles to shrink, escape, or dry out.

Firmly go over vinyl again with plastic edge.

This will ensure that vinyl is properly adhered to the surface.

5.



Once window is dry slowly remove masking ensuring that vinyl is adhered to window or surface.

Be extra careful with smaller text and punctuation.  
*(ie. periods, and dots of i's)*

Any remaining air bubbles can be poked with a needle and smoothed out.

The process is now complete and the cut vinyl is applied to the surface.

**Digital Post**

DESIGN • COPY • PRINT • SIGNS • BANNERS • PROMOTIONS